

Welcome To the Town of LeRoy

1 Municipality

1.1 Introduction to the Town of LeRoy

The Town of LeRoy is a thriving community in east central Saskatchewan. The town is an hour and a half east of Saskatoon, and two hours north of Regina. LeRoy has experienced many changes over the years and has pulled together to remain a viable rural community. Recently, approximately 100 new jobs have been directly created within the community through various projects and new businesses locating to the area.

LeRoy has in the past and will in the future continue to have a strong community spirit and a willingness to be proactive in its own livelihood. In LeRoy, people can experience a small town atmosphere with big town ideas. LeRoy is strategically located in the heart of Saskatchewan's value added agriculture industry and equipment manufacturing region. Living in the Town of LeRoy has many benefits over a larger centre as tax incentives, moderately priced housing and businesses promotions make the community a more affordable place to work and raise a family.

1.2 History

The Town of LeRoy, the Rural Municipalities' center, is surrounded by a prosperous sure-crop agricultural district. The early settlers were mostly a mix of English, Scottish, Irish and Scandinavian. The first settlers to the area were the Gregory brothers in 1903.

In 1907, the first school, known as Bog End, was built ½ mile east of the present town site. As the school and the area were known as Bog End, the Post Office assumed that name as well. In 1921, the Post Office was moved to the town site and was operated by Harry Hazeldine from his grocery store.

In 1919 planning for a new town site began on SW 13-35-20 W2 (railroad land). The Railroad named the proposed building site Unwin. When it was made known that a building site was planned, much interest was aroused regarding business enterprises and services. Starting from nothing, a lot of construction erupted and buildings appeared in rapid order for the next few years. The placement of buildings was dictated and orientated in relation to the proposed railway track.

The original name of Bog End was not considered by area residents to be a suitable name, and therefore, Bog End was changed to LeRoy on January 21, 1920, named in honor of an early settler's son. The young man was killed in France during World War I.

Railroad construction began in 1920, and railroad service commenced in 1921. This activity spurred the development of the town site businesses and services which emerged to support the development. The Village progressed rapidly in this era, with additions of restaurants, grocery stores, a hotel, lumber yards, banks, garages, elevators, blacksmiths and many other commercial ventures.

On December 5, 1922 LeRoy was incorporated as a Village and on March 1st, 1963, became a Town.

The Town of LeRoy has grown over the many years since conception and has succeeded in remaining a prosperous rural community. LeRoy is well known for its strong community spirit and ability to accomplish many projects with success.

1.3 Geophysical attributes (area size, soil types/terrain, climate)

Soil in the surrounding area is a mixture of dark gray and gray luvisolic and varies from dark brown to black, allowing a wide range of agricultural products. The physical features blend from

level farmland to rolling hills to some moderately deep valleys throughout the area. There are small lakes peppered throughout the region that provide many fishing, bird watching and other recreational opportunities.

Climate

Temperature	Jan	Feb	Mar	Apr	May	Jun
Mean Max C	-16.7	-6	-1.7	9.1	13.7	18.5
Mean C	-21.1	-11.4	-7.7	3.1	7.3	12.5
Mean Min C	-25.5	-16.8	-13.7	-3	1	6.6
Extra Max C	-3.5	4	8	24.5	25.5	28.5
Extra Min C	-47	-38	-28.5	-9.5	-7.5	0.0
Precipitation						
Rainfall Mm	0.0	T	T	18.8	42.0	63.7
Snowfall Mm	13.4	19.9	20	T	0.0	0.0
Total Mm	13.4	19.9	20	18.8	42	63.7

Temperature	Jul	Aug	Sep	Oct	Nov	Dec
Mean Max C	23.1	19.9	17.1	8.7E	2.8	-9.7
Mean C	16.7	13.7	10.1	2.8E	-3.6	-14.6
Mean Min C	10.3	7.4	3.1	-3.2	-10	-19.5
Extra Max C	31.5	29.5	23	26.5	11.5	6
Extra Min C	2.5	-3.0	-3.0	-10	-22	-33
Precipitation						
Rainfall Mm	76.7	76	56.4	16.8	0.0	T
Snowfall Mm	0.0	0.0	0.0	3.4	3.9	17.2
Total Mm	76.7	76	56.4	20.2	3.9	17.2

Source: Environment Canada 2004, E = Estimate C = Celsius T = Trace

Last Spring Frost Date	Mean First Fall Frost Date
Town of LeRoy	
<ul style="list-style-type: none"> • May 22 – 28 • May 29 – June 4 	<ul style="list-style-type: none"> • August 31 – September 6

Source: www.saskcropinsurance.com

1.4 Map of Saskatchewan (with insert showing location in Canada)

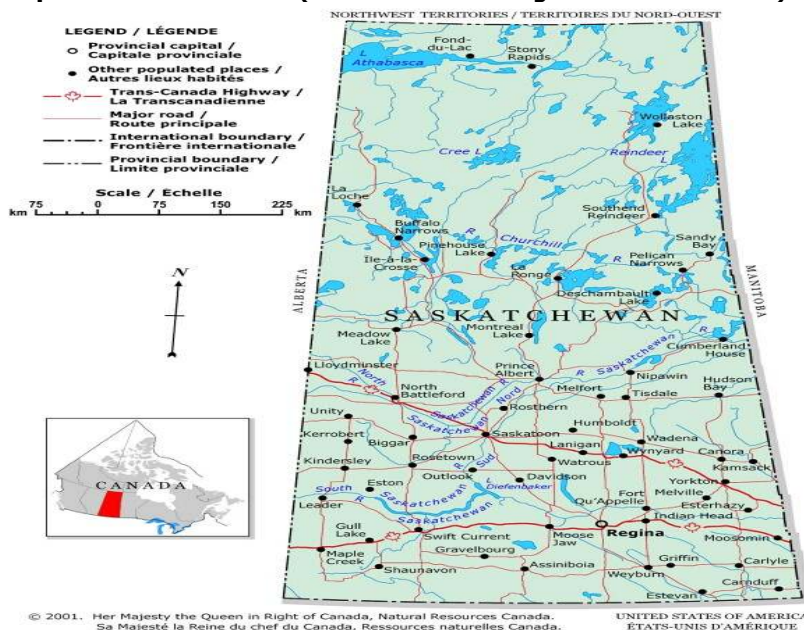

1.5 Map of the Town of LeRoy (Photo source: www.saskbiz.ca)

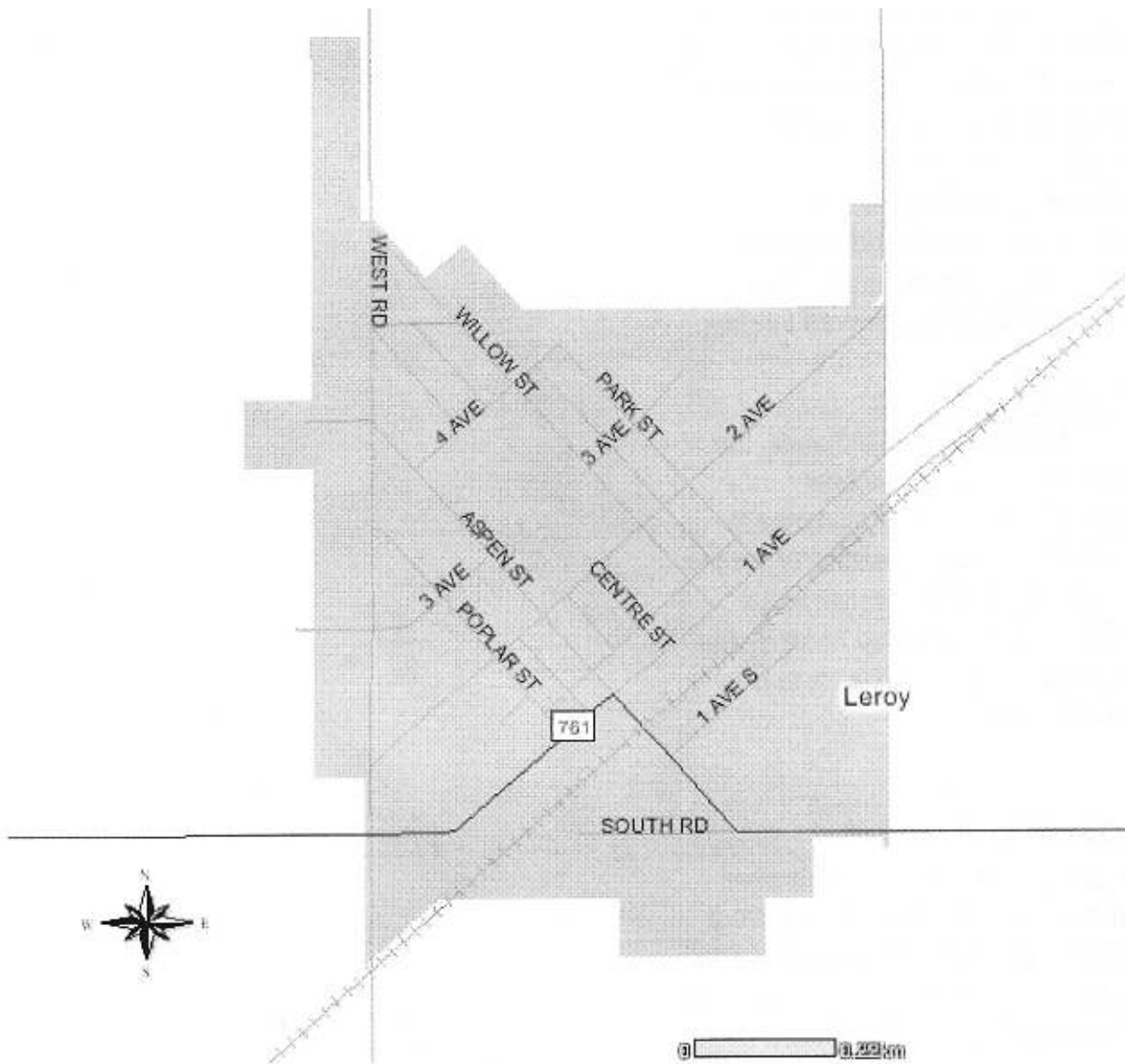

2 Business Services & Related

2.1 Financial, Professional & Technical Services for Business

- **Financial Institutions**

LeRoy Credit Union Limited
 Box 130, 101-1st Avenue NE
 LeRoy SK S0K 2P0
 Phone: 306-286-3311

- **Accountants/ Bookkeepers**

See City of Humboldt

- **Lawyers**

See City of Humboldt

- **Financial Advisors**

LeRoy Credit Union Limited
 Box 130, 101-1st Avenue NE
 LeRoy SK S0K 2P0
 Phone: 306-286-3311

- **Insurance Services, Investors Group**

Ken Crowter, Consultant
 Box 12
 LeRoy SK S0K 2P0
 Phone: 306-286-3839
 Email: ken.crowter@investorsgroup.com

LeRoy Agencies
 A Division of Western Financial Group
 Box 70, 206 Popular Street
 LeRoy SK S0K 2P0
 Phone: 306-286-3233

- **Chamber of Commerce**

N/A

2.2 Other support services for Business

• GOVERNMENT FINANACING AND BUSINESS INFORMATION	Phone Number	Toll Free Number
Aboriginal Business Service Network		1-877-699-5559
Business Development Bank of Canada	306-975-4822	1-888-463-6232
Business Infosource		1-800-667-4374
Canada Mortgage and Housing Corporation Saskatoon Branch Office	306-975-4900	1-800-309-3388
Canadian Farm Business Advisory Services		1-866-452-5558
Financial Consumer Agency of Canada		1-866-461-3222
Farm Credit Canada	306-682-3902	1-800-387-3232
Revenue Canada Business Inquiries		1-800-959-5525
Saskatchewan Corporate Registry	306-787-2962	
Small Business Loans Association Program	306-787-7154	
Western Economic Diversification Canada	306-975-4373	1-888-338-9378
Women Entrepreneurs of Saskatchewan	306-477-7173	1-800-879-6331
• PROVINCIAL LABOR LAWS AND REGULATIONS		
Human Rights Commission	306-933-5952	1-800-667-9249
Saskatchewan Labour, Employment		1-877-419-3510

Standards Branch		
• WORKER'S COMPENSATION BOARD AND OCCUPATIONAL HEALTH AND SAFETY		
Occupational Health and Safety	306-933-5052	1-800-667-5023
Worker's Compensation Board	306-933-6312	1-800-667-7590
• FOOD/LIQUOR/GAMING INDUSTRY		
Consumer Protection Branch		1-888-374-4636
Liquor and Gaming Authority	306-787-4213	
Saskatoon Health Region	306-682-8171	306-655-4500
• IMPORTING/EXPORTING		
Canada Revenue Agency		1-800-267-6999
Export Information Service Team Canada Inc.		1-888-811-1119
International Trade Canada		1-800-267-8376
• ENVIRONMENT		
Conservation Data Centre	306-787-2314	
Saskatchewan Environment and Resource Management	306-787-4230	
Spill Report Centre		1-800-667-7525
• LEGAL AND ACCOUNTING ADVICE		
Certified General Accountants Association of Saskatchewan	306-955-4622	
Institute of Chartered Accountants of Saskatchewan	306-359-1010	
Law Society of Saskatchewan	306-569-8242	

2.3 Regional Business Directory (link)

For a complete listing of businesses, visit www.carltontrailregion.ca. Click the link to the Business Directory at the top of the page, and search for businesses by location, business type, or key word.

3 Communication/Media

3.1 Cable Television/Satellite

Bell Express Vu
 Toll Free 1-888-759-3473
 Fax: 1-888-874-0000
 Website: www.bell.ca/satellite

Star Choice Communications Inc.
 2924 11th Street N.E.
 Calgary AB T2E 7L7
 Toll Free: 1-866-782-7932
 Website: www.starchoice.com

Persona Communications
 Box 4005, 3552-78th Avenue
 Edmonton AB T6E 4S8
 Phone: 780-440-2525
 Toll Free: 1-866-737-7662
 Website: www.persona.ca

IMAGE Wireless Communications
 #36, 2nd Avenue North
 Yorkton SK S3N 1G2
 Phone: 306-782-4388
 Toll Free: 1-888-462-4388
 Fax: 306-786-7686
 Website: <http://www.imagewireless.ca>

3.2 Internet Services

JPK Computers – SaskTel High Speed
 Internet Dealer
 1309 - 8th Avenue
 Humboldt SK S0K 2A0
 Phone: 306-682-2743
 Email: jpk@sasktel.net
 Website: www.jpk.ca

Persona Communications
 Box 4005, 3552-78th Avenue
 Edmonton AB T6E 4S8
 Phone: 780-440-2525
 Toll Free: 1-866-737-7662
 Website: www.persona.ca

SaskTel Internet Services
 Box 2121
 Regina SK S4P 4C5
 Toll Free: 1-800-727-5835
 Website: www.sasktel.ca

Your Link Inc.
 1359 Fletcher Road
 Saskatoon SK S7M 5H5
 Toll Free: 1-866-650-5465
 Website: www.yourlink.ca

3.3 Local Regional Newspapers

Newspaper	Telephone	Fax	Published
East Central Connection	306-287-4388	306-287-3308	Weekly in Watson & distributed in surrounding communities
Humboldt Journal	306-682-2561	306-682-3322	Weekly in Humboldt & distributed in surrounding communities
Humboldt Trader	306-682-2561	306-682-3322	Weekly in Humboldt & distributed in surrounding communities
Lanigan Advisor	306-365-2010	306-365-3388	Weekly in Lanigan & distributed in surrounding communities
Northeast Sun	306-752-5737	306-752-5358	Weekly in Melfort and distributed in surrounding communities
Regina Leader Post	306-781-5211	306-781-5484	Daily in Regina and distributed in surrounding communities
Saskatoon Star Phoenix	306-657-6320	306-657-6438	Daily in Saskatoon and distributed in surrounding communities
The Wakaw Recorder	306-233-4325	306-233-4386	Weekly in Wakaw and distributed

			in surrounding communities
Toronto Globe And Mail	800-387-5400	416-585-5102	Daily in Saskatoon and distributed in surrounding communities
Wadena News	306-338-2231	306-338-3421	Weekly in Wadena and distributed in surrounding communities
Wynyard Advance	306-554-2224	306-554-3226	Weekly in Wynyard and distributed in surrounding communities

3.4 Radio Stations

Name	City/Town	Phone Number	Fax Number
620 CKRM AM	Regina	306-546-6200	306-781-7338
650 CKOM AM	Saskatoon	306-934-2222	306-477-0002
900 CKBI AM	Prince Albert	306-763-7421	306-764-1850
980 CJME AM	Regina	306-525-0000	306-347-8557
99.1 FM	Prince Albert	306-763-7421	306-764-1850
C95, Rock 102 FM	Saskatoon	306-244-1975	306-665-5501
Canadian Broadcasting Corporation	Saskatoon	306-956-7400	
CFCR FM 90.5	Saskatoon	306-664-6678	306-665-5501
CJVR FM 100.3	Melfort	800-668-2587	306-752-5932
CJWW Radio 600 AM	Saskatoon	306-244-1975	306-665-5501
CJYM 1330 - CRYM 1210	Rosetown	306-652-0188	
CK 750 Oldies	Melfort	306-752-2587	306-752-5932
CKRM 620	Regina	306-546-6200	306-781-7338
Country 100.7	Moose Jaw	306-692-1007	306-692-8880
CRQC 600 AM	Saskatoon	306-244-1975	306-665-5501
Hot 93 FM	Saskatoon	306-244-1975	306-665-5501
Lite 92 / CHMX FM	Regina	306-546-6211	306-946-6210
Magic 98.3 FM	Saskatoon	306-244-1975	306-665-5501
Radio Canada	Saskatoon	306-956-7400	
Rawlco Radio	Saskatoon	306-934-2222	306-477-0002
Rock 94.5	Regina	306-525-0000	306-359-3968
WOLF 104.9	Regina	306-781-7338	

3.5 Telephone

Service Provider

SaskTel is responsible for telephone communications in the Province of Saskatchewan.

- Main switchboard line 1-800-727-5835
- 911 recovery charge of 59 cents on all invoices
- Residential basic connection fees for existing line \$22; house call connection \$75; new line \$75 plus \$25 additional jacks
- Two residential bundle packages available - evening and weekends \$25; Anytime anywhere in North America - \$35 (bundle cost is in addition to basic rental)
- Business basic connection fees: existing line in office/building \$45; new line connection to the business \$99; plus additional jack \$87
- Farm connection: new residential \$475; new business \$499
- For more information please see Sasktel website: www.sasktel.com

Cellular Telephone

- SaskTel Mobility – 1-800-667-2355
- Website: www.sasktelmobility.com
- TELUS Mobility
2nd Avenue S.E.
Calgary AB T2A 5N7
Phone: 403-387-5825

Toll-Free: 1-866-558-2273
Website: www.telusmobility.com

3.6 Postal Service

LeRoy Post Office
125 Aspen Street
LeRoy SK S0K 2P0
Toll Free: 1-800-267-1177

Lobby Hours: 0:00 - 24:00
Counter Hours: 8:30 - 17:00

4 Demographics of the Town of LeRoy

4.1 Population Breakdown

Characteristics - Population	
Population in 2006	412
Population in 2001	413
2001 to 2006 Population Change (%)	-0.2
Total Private Dwellings	189
Population Density Per Square Kilometer	388
Land Area (Square Kilometer)	1.06

Source: Statistics Canada 2006, www.statcan.ca

Characteristics - Population	Total	Male	Female
Age Characteristics of the Population			
Total -All Persons	410	220	195
Age 0 - 4	10	10	0
Age 5 - 14	45	20	20
Age 15 -19	35	25	15
Age 20 - 24	20	15	5
Age 25 - 44	95	45	50
Age 45 -54	80	45	30
Age 55 -64	40	25	15
Age 65- 74	25	20	10
Age 75 - 84	40	10	30
Age 85 and over	25	10	15
Median age of the population	45.1	44.1	46.4
% of the Population ages 15 years and over	85.5	84.1	84.6
Common-law Status			
Total - Population 15 years and over	355	190	170
Not in a common-law relationship	340	180	160
In a common-law relationship	15	5	5
Legal Marital Status			
Total Population 15 years and over	355	190	170
Single	100	65	30
Married	185	95	95
Separated	15	5	5
Divorced	20	10	5
Widowed	45	10	35

Source: Statistics Canada 2006,
www.statcan.ca

Characteristics	Total	Male	Female
Immigration Characteristics			
Total - All Persons	410	210	200
Canadian-born Population	390	200	190
Foreign-born Population	15	0	10
Immigrated before 1991	20	0	10
Immigrated Between 1991 and 2006	0	0	0
Non-permanent Residents	0	0	0

Aboriginal Population			
Total All Persons	410	215	200
Aboriginal Identity Population	0	0	0
Non-Aboriginal Population	410	210	200
Visible Minority Status			
Total Population by Visible Minority Groups			
Visible Minority Population	0	0	0

Source: Statistics Canada 2006,
www.statcan.ca

Characteristics - Language	Total	Male	Female
Language(s) First Learned and Still Understood			
Total All Persons	410	210	200
English Only	410	210	200
French Only	0	0	0
Both English and French	0	0	0
Other Languages	0	0	0

Source: Statistics Canada 2006,
www.statcan.ca

Characteristics	Families and Dwellings
Selected Family Characteristics	
Total Number of Families	110
Number of Married Couple Families	90
Average Number of Persons in Married Couple Families	3.1
Number of Common-law Couple Families	10
Average Number of Persons in Common-law Couple Families	0
Number of Lone-parent Families	20
Average Number of Persons in Lone-parent Families	0.0
Number of Female Lone-parent Families	0
Average Number of Persons in Female Lone-parent Families	0.0
Number of Male Lone-parent Families	10
Average Number of Persons in Male Lone-parent Families	0.0
Median Family Income(\$) - All Census Families	
Median Family Income (\$) - Couple Families	
Median Family Income (\$) - Lone-parent Families	
Selected Household Characteristics	
Total - All Private Households	170
Households Containing a Couple Married or common-law) With Children	40
Households Containing a Couple Married or common-law) Without Children	45
One Person Households	60
Other Household Types	20
Median Household Income (\$) - All Households	
Median Household Income (\$) - One Person Households	
Median Household Income (\$) - Two Or More Person Households	
Number of Rented Dwellings	25
Average Gross Monthly Payments For Rented Dwellings (\$)	

Number of Owner Occupied Dwellings	145
Average Monthly Payments For Owner Occupied Dwellings (\$)	
Selected Occupied Private Dwelling Characteristics	
Total Number of Dwellings	175
Number of Owned Dwellings	145
Number of Rented Dwellings	25
Number of Dwellings Constructed Before 1986	155
Number of Dwellings Constructed Between 1986 and 2006	15
Average Value of Dwelling	

Source: Statistics Canada 2006, www.statcan.ca

4.2 Income

Characteristics - Income	
Persons 15 Years of Age and over with Income	340
Median Total Income of Persons 15 Years of age & over (\$)	16,375
Composition of Total Income (100%)	100.0
Earnings - % of Income	63.1
Government Transfers - % of Income	26.0
Other Money - % of Income	10.8

Source: Statistics Canada 2001, www.statcan.ca

5 Economic Base

5.1 Municipal Economic Strengths

Economic Strengths of the Town of LeRoy include:

- Located in the heart of Saskatchewan's valuable agricultural equipment manufacturing area
- Diversity of the area includes potash mining, construction, manufacturing, grain farming and specialty agriculture
- Proactive Council
- Large, well established farms in the area
- Affordable housing

5.2 Industry Profile

5.2.1 Agriculture

5.2.1.1 Regional Agriculture Overview

Saskatchewan has often been referred to as "***The Breadbasket of the World***". Grains, oilseeds, dairy, livestock and poultry, fruit and vegetables are some of the examples of products grown in Saskatchewan and sold throughout the world. Approximately 45% of the entire area of Saskatchewan is farmland. Wheat and barley are two of the most important grains grown. Other significant crops grown are oats, rye, flax, canola, mustard and lentils, with numerous others grown on a smaller volume basis. The Carlton Trail region has been called "*The Sure Crop District*" since this region has rarely seen a crop failure in the past 100 years. In the Carlton Trail region there are three major pork producers based out of the region - Big Sky Farms, one of the largest producers in Western Canada; Stomp Pork Farms, and Sinnet Pork Farms. There are also dairy cattle, poultry and other exotic animals raised in the area. A fully integrated beef feed lot/ethanol plant is also located near Lanigan - Pound-Maker Agventures.

The significance of agriculture to Saskatchewan goes well beyond the products that we grow. It also involves all of the related agri-businesses that process these products, such as bagging, bio fuels (bio diesel and ethanol), crop cleaning and food processing. Inter-related businesses, such as agricultural machinery manufacturing, maintenance and repair, trucking and other transportation, fertilizer/fuel/pesticide/herbicide distribution, etc., contribute to the agriculture sector. These contributions, from all agriculture associated businesses are the leading contributor to the GDP in Saskatchewan.

5.2.1.2 Local Agriculture Overview

N/A

5.2.2 Manufacturing

5.2.2.1 Regional Manufacturing Overview

Saskatchewan's Manufacturing Industry has a very diverse base. The largest manufacturing industries in Saskatchewan include chemical, machinery, food, fabricated metal production and wood, with over 30,300 people employed in this industry provincially. In the Carlton Trail region there are several businesses that specialize in manufacturing agricultural or related equipment, (Bourgault Industries, Del-Air Systems Ltd., Doepker Industries, FP Bourgault Tillage Tools, Prairie Agriculture Machinery Institute (PAMI), Schulte Industries). Examples where this equipment would be used are, for tillage and rock removal, spraying and fertilizing, livestock, forage and grain handling, storage and transportation. This top of the line equipment can be found throughout the world including: the United States, Mexico, Western Europe, Australia, South America, among others.

5.2.2.2 Local Manufacturing Overview

Country Wood 88 Cabinet Finishing
107 Aspen Street
LeRoy SK S0K 2P0
Phone: 306-286-3289

5.2.3 Mining

5.2.3.1 Regional Mining Overview

Mining is the third largest industry in Saskatchewan after oil, gas and agriculture. The province is part of the Canadian Shield, where many metals and minerals are found. Saskatchewan produces a third of the world's supply of potash. Saskatchewan is one of Canada's top three mineral producing provinces. This industry creates approximately 20,000 direct and indirect jobs. The potash reserves in Saskatchewan are enormous. Saskatchewan is the largest potash producer and exporter in the world, supplying over one third of the world demand. By moderate estimates, Saskatchewan could supply the current levels of world demand for potash for several hundred years. In the Carlton Trail region there are two Potash mines, one located in Lanigan and the other in Colonsay. There is also a Sulphate of Potash/Potassium Sulphate mine closer to Wynyard.

Regional mining contact information operating in the CTREDA region:

Big Quill Resources Inc.
(Potassium Sulphate Plant)
Box 1059
Wynyard SK S0A 4T0
Phone: 306-554-3322
Fax: 306-554-3858
Website: www.biquill.com

Mosaic Potash Colonsay
(Potash Mine)
Box 1500
Colonsay SK S0K 0Z0
Phone: 306-944-2223
Fax: 306-944-4245
Website: www.mosaicco.com

PCS Potash Lanigan Division
(Potash Mine)
Box 3100
Lanigan SK S0K 2M0
Phone: 306-365-2030
Fax: 306-365-2526
Website: www.potashcorp.com

5.2.3.2 Local Mining Overview

The Town of LeRoy is located approximately 65 kilometres east of the Potash Corporation of Saskatchewan – Lanigan Division. Many residents commute to this local mine for work.

5.2.4 Tourism

5.2.4.1 Regional Tourism Overview

Saskatchewan offers numerous parks (some have golf courses within the park) and shimmering lakes to enjoy, along with the unique beauty of the province, one of which are our magnificent sunsets. This peaceful scenery is the reason why Saskatchewan's theme is the "**Land of the Living Skies**". With large wilderness regions to explore there are many opportunities for bird watching. Be amazed by the history and beauty of St. Peter's Cathedral at Muenster or admire the wilderness of the Wadena Wetlands and the Quill Lakes areas to experience first hand, natural wildlife and bird habitats. Over 3,400 tourism businesses, events, attractions and organizations are located throughout the province, many of which are found within the Carlton Trail tourism region. Fishing, skiing, snowmobiling, golfing, and hiking are other recreations found in the area. Visit the City of Humboldt to learn more about the region's heritage,

diverse cultures, tourism services and other unique offerings throughout the entire area.

5.2.4.2 Local Tourism Overview

One of the Town’s main attractions is the LeRoy and District Heritage Museum. For local tourism information, call the Town Office: 306-286-3288

5.3 Regional Trading Area (sales of grain, livestock, purchase of machinery, consumer spending)

The City of Humboldt is the major trading center in the area. In 2004, the trading area totalled 26,314 people. The total population in Humboldt’s trading area was determined on two counts:

- 1) Calculating by towns, villages and RMs
- 2) A break-down of 0-50 km radius and 51-80 km radius which is shown in the accompanying table.

Towns	9,603	0 – 50 km radius	9,169
Villages	6,186	51 – 80 km radius	11,543
Rural Municipalities	4,923		
Subtotal	20,712	Subtotal	20,712
Humboldt	5,602	Humboldt	5,602
Total	26,314	Total	26,314

Source: Covered Population 2004, Saskatchewan Health

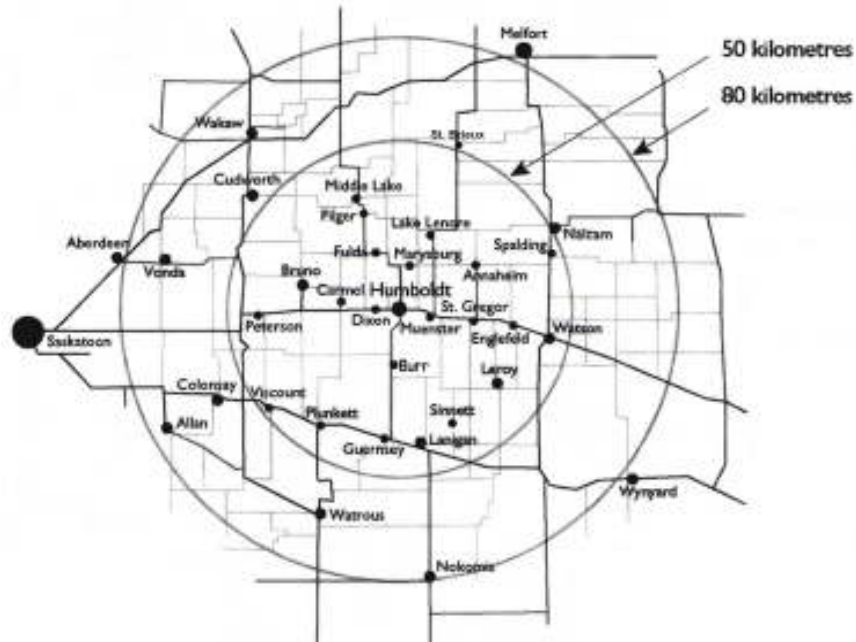

5.4 Industrial/Commercial/Agricultural Land Availability

Commercial lots are available in the Town of LeRoy, starting at \$25.00 per frontage foot. Contact the Village Office for details on locations, pricing, servicing, and incentive programs:

Town of LeRoy
 Box 40
 LeRoy SK S0K 2P0
 Contact: Ann Block 306-286-3288

5.5 Employment Statistics

Characteristics - Earnings	Total	Male	Female
All persons With Earnings (counts)	235	130	105
Average Earnings (all persons with earnings (\$))	17,127	19,211	14,517
Worked Full Year, Full Time (Counts)	90	55	30
Average Earnings (worked full year, full time (\$))	22,612	20,467	26,673

Source: Statistics Canada 2001, www.statcan.ca

5.6 Regional Labour Market

5.6.1 Private Sector

Annaheim

Doepker Industries 306-598-2171 www.doepker.com

Colonsay

Mosaic Potash Mine 306 944-2223 www.mosaicco.com

Cudworth

Cudworth Pork Investors Group
Incorporated 306 256-3488

Dafoe

Lakeside Gloval Processors 306 554-3264 www.lakesideglobal.ca

Drake

Bergen Industries Incorporated 306 363-2131 www.bergenindustries.com
Drake Meat Processors 306 363 2117 www.drakemeats.com

Englefeld

Koenders Manufacturing 1979 Limited 306 287 3139 www.koendersmfq.com
Schulte Industries Limited 306 287 3715 www.schulte.ca

Humboldt

Bella Vista Inn 306 682 2686 www.bvinn.sasktelwebsite.net
Big Sky Farms 306 682 5041 www.bigsky.sk.ca
CIM Industries 306 682 2505 www.cim-ltd.ca
Colony Motor Products 306 682 2661 www.colonypontiac.gmcanada.com
Conexus Credit Union 306 682 2696
1 800 667477 www.conexus.ca

Del-Air Systems/Romperland 306 682 5011 www.del-air.com
Discovery Ford Sales Limited 306 682 2652 www.discoveryfordsales.com
Extra Foods www.extrafoods.ca

Humboldt Co-Op Association 306 682 2632
Humboldt IGA 306 682 2130
Humboldt Lumber Mart Limited 306 682 2527 www.rona.ca
Pioneer Grain 306 682 1730 www.jri.ca

Pioneer Hotel & Johnny's Bistro 306 286 2638 www.thepioneerhotel.com
South 20 Dodge Chrysler Limited 306 682 3900 www.south20.ca
Tasko Home Hardware 306 682 5565 www.homehardware.ca
Viterra (Sask. Wheat Pool) 306 682 0711 www.viterra.ca

Lanigan

Potash Corporation, Lanigan Division 306 365 2030 www.potashcorp.com
Pound-Maker Agventures 306 365 4281 www.pound-maker.ca

LeRoy

Stomp Port Farms 306 366 2211 www.stompporkfarm.com
Midway Co-Op 306 286 3202

St. Gregor

Michel's Industries Limited 306 366 2184 www.michels.ca

St. Brieux

Bourgault Industries Limited 306 275 2300 www.bourgaultindustries.com
Del-Air 2000 Incorporated 306 275 4848 www.dryair.ca

Freeform Plastic Products Incorporated
F.P. Bourgault Tillage Tools Limited 306 275 2155 www.freeformplastics.com
Precision Profiles Plus 306 275 4500 www.bourgaulttillage.com
306 275 4800 www.precisionprofiles.ca

Vonda		
Highline Manufacturing	306 258 2233	www.highlinemfg.com
Wakaw		
Country Crossroads Services	306 233 5551	www.countrycrossroads.ca
Wadena		
Nielson Trucking Limited	306 338 3330	
North East Terminal Limited	306 338 2999	www.northeastterminal.com
Wadena Cooperative Association Limited	306 338 2356	
Watson		
Central Water Conditioning	306 287 3633	www.centralwater.ca
Chequs RV Sales	306 387 3999	www.chequsrvsales.ca
Failure Prevention Service Limited	306 287 3210	www.fps-ss.com
Midway co-Operatives	306 286 3202	
T.C. Enterprises	306 287 3636	
Watson Motor Inn	306 287 4338	
Wynyard		
Big quill Resources	306 554 3322	www.bigquill.com
Canadian Pacific Railway		www.cpr.ca
Lilydale Poultry	306 554 2555	www.lilydale.com
Southshore Motor Lodge	306 554 2516	
Wynyard Co-Operatives	306 554 2122	www.wynyardcoop.com

For further information about job opportunities in Saskatchewan and the Carlton Trail Region, contact www.saskjobs.ca.

5.6.2 Public Sector

Cudworth		
Cudworth Nursing Home	306 256 3423	www.saskatoonhealthregion.ca
St. Michaels Havens	306 256 3444	www.saskatoonhealthregion.ca
General		
Greater Saskatoon Catholic Schools	306 659 2010	www.scs.sk.ca
Royal Canadian Mounted Police		
• Humboldt detachment	306 682 2535	
• Regina headquarters	306 780 5838	www.rcmp.ca
Humboldt		
Carlton Trail Regional College	306 682 2623	www.ctrc.sk.ca
City of Humboldt	306 682 2525	www.humboldt.ca
Saskatoon Health Region		
• Administration	306 682 5526	www.saskatoonhealthregion.ca
• Home Care	306 682 2609	www.saskatoonhealthregion.ca
St. Elizabeth's Hospital	306 682 2603	www.saskatoonhealthregion.ca
St. Mary's Villa	306 682 2628	www.saskatoonhealthregion.ca
Lanigan		
Central Parkland Lodge	306 365 1420	www.saskatoonhealthregion.ca
Lanigan Union Hospital	306 365 1400	www.saskatoonhealthregion.ca
Horizon School Division	306 365 4888	www.hzsd.ca
Middle Lake		
Bethany Pioneer Village	306 367 2933	www.saskatoonhealthregion.ca
Muenster		
St. Peter's College	306 682 4401	www.stpeterscollege.ca
St. Brieux		
Chateau Providence Inc.	306 275 2227	www.kelseytrailhealth.ca
Wadena		
Pleasant View Care Home	306 338 2412	www.saskatoonhealthregion.ca
Wadena Hospital	306 338 2515	www.saskatoonhealthregion.ca
Wakaw		
Lakeview Pioneer Home	306 233 4621	www.saskatoonhealthregion.ca
Wakaw Hospital	306 233 4611	www.saskatoonhealthregion.ca
Warman		
Prairie Spirit School Division	306 933-4414	www.spiritsd.ca
Watson		
Quill Plains Centennial Lodge	306 287 3232	www.saskatoonhealthregion.ca
Wynyard		

Golden Acres
Wynyard Hospital

306 554 2586 www.saskatoonhealthregion.ca
306 554 2586 www.saskatoonhealthregion.ca

For further information about job opportunities in Saskatchewan and the Carlton Trail Region, contact www.saskjobs.ca

5.7 Regional Employment Services/Training

Canada –Saskatchewan Career and Employment Services
Box 2198, 623 - 7th Street
Humboldt SK S0K 2A0
Phone: 306-682-6772
Fax: 306-682-6774
Website: carol.weiman@sasked.gov.sk.ca

Canada – Saskatchewan Career and Employment Services
Box 219, 310 Avenue B West
Wynyard SK S0A 4T0
Phone: 306-554-5450
Fax: 306-554-5454
Website: www.saskjobs.ca

Newsask Community Futures Development Corporation
Box 357, 903 - 99th Avenue
Tisdale SK S0E 1T0
Phone: 306-873-4449
Toll Free: 1-888-586-9855
Fax: 306-873-4645
Email: admin@newsaskcfdc.ca
Website: www.newsaskcfdc.ca

Sagehill Community Futures Development Corporation
Box 10, 515 Mayer Street
Bruno SK S0K 0S0
Phone: 306-369-2610
Toll Free: 1-888-732-8999
Fax: 306-369-4142
Email: info@sagehill.ca
Website: www.sagehill.ca

Ventures Community Futures Development Corporation
Box 1180, Highway 10 East
Yorkton SK S3N 2X3
Phone: 306-782-0255
Toll Free: 1-877-782-0255
Fax: 306-783-2590
Website: www.venturescfdc.com

6 Education Services

6.1 School Districts – Carlton Trail Region

Greater Saskatoon Catholic Schools
420-22nd Street East
Saskatoon SK S7K 1X3
Phone: 306-659-7000
Fax: 306-659-2010
Website: www.scs.sk.ca

Englefeld Protestant Separate School Division #132
Box 984
Wadena SK S0A 4J0
Phone: 306-338-3630
Fax: 306-338-3276
Email: bowers@sasktel.net

Horizon School Division
Box 100
Lanigan SK S0K 2M0
Phone: 306-365-4888
Fax: 306-365-2808

Wadena Service Centre
Box 160
Wadena SK S0A 4J0
Phone: 306-338-2325
Fax: 306-338-3527

Humboldt Service Centre
Hwy 5 East
Humboldt SK S0K 2A0
Phone: 306-682-2558
Fax: 306-682-5154

Prairie Spirit School Division
Box 809
121 Klassen St. E
Warman SK S0K 4S0
Phone: 306-933-4414
Fax: 306-934-8221

6.1.1 Separate Schools

N/A

6.1.2 Public Schools

LeRoy School
Corner of 4th Avenue & Willow
LeRoy SK S0K 0P0
Phone: 306-286-3313

6.1.3 Hutterite Schools

N/A

6.2 Colleges

Young people within the Carlton Trail REDA region normally attend these Colleges:

Carlton Trail Regional College
CEO: Rob Barber
623 – 7th Street
Humboldt SK S0K 2A0
Phone: 306-682-2623
Toll Free: 1-800-667-2623
Fax: 306-682-3101
Email: humboldt@ctr.sk.ca
Website: www.ctr.sk.ca

St. Peter's College
(University of Saskatchewan Affiliate)
President: Rob Harasymchuk
Box 40
Muenster SK S0K 2Y0
Phone: 306-682-7888
Fax: 306-682-4402
Email: spc@stpeters.sk.ca
Website: www.stpeterscollege.ca

6.3 Universities / Technical Schools

Young people within the Carlton Trail REDA region normally attend these Universities:

University of Regina
3737 Wascana Parkway
Regina SK S4S 0A2
Phone: 306-585-4360
Website: www.uregina.ca

University of Saskatchewan
Administration Bldg
105 Administration Place
Saskatoon SK S7N 5A2
Phone: 306-966-4343
Website: www.usask.ca

SIAST (Saskatchewan Institute of
Applied Science & Technology)
Idylwyld Drive & 33rd Street
Saskatoon SK S7K 3R5
Phone: 306-933-6350
Website: www.siastr.sk.ca

7 Energy and Other Utilities

7.1 Electricity

SaskPower	Residential			Business		Small Commercial		Manufacturing & Processing		Farm
	City/Town Village & Urban Resort	Rural & Rural Resort		Urban	Rural	Urban	Rural	Urban	Rural	
Rate Code	E01*	E02*	E03*	E05*	E06*	E75*	E76*	E65*	E66*	E34*
Basic Monthly Charge	\$15.31	\$15.31	\$21.42	\$33.92	\$41.80	\$18.92	\$27.45	\$28.75	\$41.80	\$24.19
Demand Charge										
First 50 kV.A/mo				0	0	0	0	0	0	0
Balance \$/kV.A	\$9.38	\$9.38	\$9.67	\$10.71	\$11.08	\$10.38	\$10.95	\$10.44	\$12.25	\$8.80
Energy Charge										
First Block KW.h/mo				16,750 kWh	15,500 kWh	14,500 kWh	13,250 kWh	16,750 kWh	15,500 kWh	16,000 kWh
First Block (c/kW.h)				8.31c	8.56c	8.57c	9.17c	8.11c	8.56c	8.35c
Balance (c/kW.h)				5.139c	5.133c	5.153c	5.109c	4.60c	4.316c	4.512c

c = cents Source: www.saskpower.com February 1, 2007

Residential:

Minimum Bill – the basic monthly charge

For customer service, call 1-888-757-6937; two pieces of identification are required for hook up to services.

Business; Small Commercial; Manufacturing & Processing:

Minimum Bill – The basic monthly charge plus \$3.00/kV.A of the maximum recorded demand over 50 kV.A registered over the past eleven months.

Farm:

Minimum Bill – The basic monthly charge plus \$3.00/kV.A of the maximum demand over 50 kV.A registered over the past eleven months.

Electric Rate Disclaimer:

The rates herein defined are net and do not include any taxes or surcharges, which may lawfully be imposed by or at the request of any municipal, provincial or federal authority.

For more information please check SaskPower website: www.saskpower.com

7.2 Natural Gas

SaskEnergy	Domestic		Commercial	
	Residential & Cottages	Farm & Agricultural (0 to 10,000 m3/yr)	General Service II	General Service III
Rate Code	G01	G17	G02	G03
Basic Monthly Charge 3(\$)	12.50	14.05	20.65	43.50
Delivery Charge (c/m3)*	7.10	7.10	7.10	6.31

Gas Consumption Charge (c/m ³)*	24.59	24.59	24.59	24.59
---------------------------------------------	-------	-------	-------	-------

*c = cents

Source: www.saskenergy.com

November 1, 2007

Domestic:

Minimum Bill – The basic monthly charge
For Customer Service, call 1-306-777-9376

Energy Rate Disclaimer:

Any taxes, levies or surcharges which may be lawfully imposed by or at the request of any municipal, provincial, or federal authority will be charged to the customer as required.

For more information please check SaskEnergy website: www.saskenergy.com

7.3 Water & Sewer

Water System:

- Current Town water system is well water, treated with a reverse osmosis treatment system; the system was installed in 2005 (water softeners and reverse osmosis systems are no longer used by residents)
- Capacity is listed at 1000
- Rates: \$16.00 per month for the first 2,000 gallons
\$.60 per 100 gallons thereafter

Sewer System:

- Current sewage system is gravity type to a lagoon
- Capacity is listed at 700-750
- Sewer rates: \$11.00 per month

7.4 Waste Management

7.4.1 Landfill Site(s)

Landfill / Transfer Stations	Summer Hours	Winter Hours	Directions	Contact Phone Number
Annaheim Transfer Station	Saturday: 10am-2pm	First Saturday of the month	3 miles E and 1 mile south	306-682-1955
Bruno Transfer Station	Wed: 2pm- 6pm Sat: 2pm-6pm	Wed: 2pm- 6pm Sat: 2pm-6pm	N/A	306-369-2514
Colonsay Transfer Station	Wed: 2pm-5pm Sat: 10am-3pm	Wed: 2pm-5pm Sat: 10am-3pm	½ mile south of Railway on Zelma Rd and E of town	306-255-2313
Drake Transfer Station	Sat: 11am-3pm	Sat: 11am-3pm	W of Village Cemetery, at southwest corner of the Village	306-363-2080 306-363-2109
Hoodoo Landfill	Mon, Wed, Sat: 10am-5pm	Mon, Wed, Sat: 10am-5pm	4 miles E of #2 Hwy on 777 grid & 5 1/2 miles N-east side of grid	306-682-1955
Humboldt Landfill	Mon-Fri: 10am-12pm and 1pm-6pm Sat: 10am-5pm	Mon-Fri: 10am-12pm and 1pm-5pm Sat: 10am-5pm	S of Hwy# 20, past Airport, west off highway	306-682-1955
Lake Lenore Transfer Station	Tues: 4pm-7pm Sat: 9:30am-1:30pm	Bin at town shop: 3pm-7pm	N/A	306-368-2344
Lanigan Transfer Station	Apr – Oct Tues: 1pm-7pm Sat: 10am-4pm	Nov – Mar Tues: 1pm-5pm Sat: 10am-4pm	2 km West of Town, ½ km N of Hwy #16; turn N on the 'heavy haul road' to Agnew Ave; west approx. 1 km to	306-365-2809 306-365-3463 306-682-1955

			site	
LeRoy Transfer Station	Wed: 2pm-6pm Sat: 11am-3pm	Wed: 2pm-6pm Sat: 11am-3pm	½ mile NW of the Town, following 2 nd Ave.NE	306-682-1955
Meacham Transfer Station	Tues: 2pm-5pm Sat: 9am-12pm	Tues: 2pm-5pm Sat: 9am-12pm	1 mile S of town	306-276-2003
Middle Lake Transfer Station	Tues:12pm-4pm Sat: 12pm-4pm	Tues:12pm-4pm Sat: 12pm-4pm	N/A	306-367-2149
Quill Lake Transfer Station	Wed, Sat: 9am-1pm	Wed, Sat: 9am-1pm	Main Street South	306-383-2592
Spalding Landfill	Open * Compost only	Open * Compost only	Across the street from Town Office on Hwy#6	306-872-2166
St. Brieux Transfer Station	May 1- Oct. 31 Tues: 1pm-5pm Sat: 8am-12pm and 1pm-5pm	Nov. 1 - Apr. 30 Sat: 8am-12pm and 1pm-5pm	E of Hwy 368 & Barbier Drive ½ mile, on south side of road	306-275-2257 (or) 306-682-1955
Wakaw Transfer Station	Tues, Thurs, Sat: 10am-5pm	Thurs, Sat: 10am-5pm	½ km W of 3 rd St N	306-233-4223
Watrous Transfer Station	Tues, Thurs: 1pm-7pm Sat: 9am-5pm	Tues, Thurs: 12pm-5:30pm Sat: 10am-4pm	N/A	306-682-1955
Watson Transfer Station	Wed: 2pm-6pm Sat: 11am-3pm	Wed: 2pm-6pm Sat: 11am-3pm	1 km W of Watson on Hwy 5, then 1 km south on ADM road	306-682-1955
Wynyard Landfill Site	Tues, Thurs, Fri: 1pm-4:30pm	Tues, Thurs, Fri: 1pm-4:30pm	3.2 kms N of Wynyard on 640 Grid and 3.2 kms W	306-554-2123

Landfills collect used oil, oil jugs, oil filters, scrap metals, grain screenings, compost, wood and wood products and household waste. They also accept construction rubble, asphalt, concrete, etc.

Transfer stations can collect used oil, oil jugs, oil filters, scrap metals, and accept wood, wood products and household waste.

See the following map to locate the landfill sites

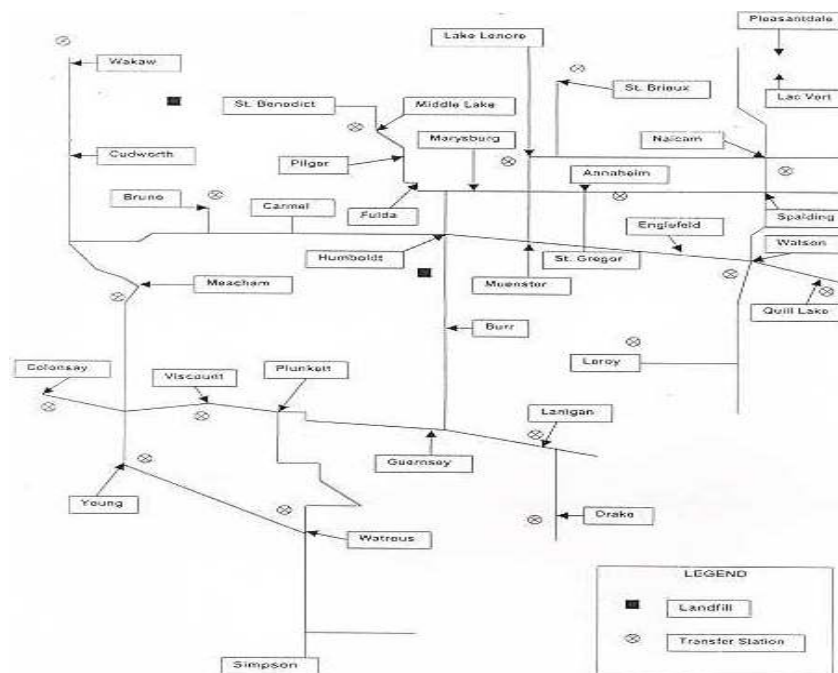

7.4.2 Garbage Removal

- Residential and commercial garbage collection is provided by REACT Waste Management Program
- Garbage is picked up every Thursday morning
- REACT waste tickets (to be placed on each bag of garbage) may be purchased at the Midway Co-op Grocery Store or the Town Office, (5 tickets for \$5; 100 tickets for \$90)
- Garbage bags are not to weigh more than 20 kg (44 lbs)

7.4.3 Recycling

SARCAN Recycling is the recycling division of the Saskatchewan Association of Rehabilitation Centres (SARC), which strives to provide employment for people with disabilities, protect the environment and contributes to the economic development of our province.

- Accepts for refund all non-refillable, ready-to-serve beverage containers, excluding milk containers;
- Accepts beer bottles at a reduced refund of \$0.04 per bottle
- Accepts for recycling milk cartons, newspapers, cardboard, tin cans etc.
- See website for more information www.sarcsarc.ca

SARCAN depots in our East Central Region:

Humboldt	629-2 nd Street	Phone: 306-682-4744
Lanigan	57 Main Street	Phone: 306-682-4744
Viscount	102 Bagot Street	Phone: 306-944-4810
Wadena	109-2 nd St. South West	Phone: 306-338-3322
Watson	1 st Street West	Phone: 306-287-3120
Wynyard	1 st Street East	Phone: 306-554-3453

7.4.4 Hazardous Waste

N/A

7.4.5 Composting

N/A

8 Government

8.1 Local Municipal Government

Town of LeRoy
100-1st Avenue Northeast
Box 40
LeRoy SK S0K 2P0
Phone: 306-286-3288
Fax: 306-286-3400
Email: leroy@bogend.ca
Website: www.leroy.ca

Municipal Staff:

Town Administrator:	Ann Block
Assistant Administrator:	Glenda Hamilton
Public Works:	Lloyd Taphorn
Recreation Director:	Patti Binsfeld

Mayor:	Morris Hartman
Councillors:	Keith Dale
	Ken Crowter
	Ben Dyck
	Denis McKnight
	Brian Thoen
	Bill Work

8.2 Neighbouring Municipalities

R.M. of LeRoy #339
Box 100, 100-1st Avenue Northeast
LeRoy SK S0K 2P0
Phone: 306-286-3261
Fax: 306-286-3400
Email: rm339@sasktel.net

Town of Lanigan
Box 280, 26 Main Street
Lanigan SK S0K 2M0
Phone: 306-365-2809
Fax: 306-365-2960
Email: town.lanigan@sasktel.net

8.3 Provincial Government

Member of the Legislative Assembly –
Humboldt
(Minister of Social Services)
Honourable Donna Harpauer,
Saskatchewan Party
Box 2950
Humboldt SK S0K 2A0
Phone: 306-682-5141
Toll-Free: 1-800-682-9909
Fax: 306-682-5144
Email: humboldtmla@sasktel.net
Website: www.legassembly.sk.ca

Member of the Legislative Assembly –
Batoche
Mr. Delbert Kirsch
Box 308
Cudworth SK S0K 1B0
Phone: 306-256-3930

Member of the Legislative Assembly – Kelvington -
Wadena
Honourable June Draude
(Minister of First Nations and Metis Relations)
(Minister responsible for Northern Affairs)
Box 369, 110 Main Street
Wadena SK S0A 4J0
Phone: 306-338-3973
Email: minister.fnmr@gov.sk.ca

Member of the Legislative Assembly – Melfort
(Minister of Finance)
Honourable Rod Gantfoer
Box 2800
Melfort SK S0E 1A0
Phone: 306-752-9005

Email: batochemla@sasktel.net

Email: rgantefoer@mha.legassembly.sk.ca

8.4 Federal Government

Member of Parliament
Mr. Brad Trost

Humboldt Office:
Humboldt Mall
1919A – 8th Avenue Unit R-24
Humboldt SK S0K 2A0
Phone: 306-682-8515
Fax: 306-682-8510
Email: trost.mp4@sasktel.net

Ottawa Office:
House of Commons
Ottawa ON K1A 0A6
Phone: 613-992-8052
Fax: 613-996-9899
Email: trost.b@parl.gc.ca

9 Health, Wellness & Social Services

9.1 Health District

All communities within the Carlton Trail REDA region are a part of the Saskatoon Health District. The Saskatoon Health Region (SHR) is an integrated health delivery agency that offers hospital, long term care, public health, home care services and other health care services.

Services provided by SHR in the rural areas

- Acute care
- Long term care
- Home care
- Palliative care
- Public health
- Mental health
- (Adult and child & youth) health promotion & education
- Nutrition
- Acquired brain injury program
- Chemotherapy program at St. Elizabeth's Hospital
- Volunteer
- Ambulance services
- Addiction services
- Meals on wheels
- Physio/occupational Therapy services
- Lab and diagnostic

Acute care hospital locations

- Humboldt
- Wadena
- Wynyard
- Lanigan
- Watrous
- Rosthern
- Wakaw

Long term care facility locations

- Cudworth
- Middle Lake
- Humboldt
- Watson
- Wadena
- Rosthern
- Wakaw
- Duck Lake
- Lanigan
- Wynyard
- Watrous
- Nokomis
- Strasbourg

Maura Davies, President &
Chief Executive Officer
Saskatoon Health Region
3rd Floor – Saskatoon Square
410 – 22nd Street East
Saskatoon SK S7K 5T6
Phone: 306-655-3322
Fax: 306-655-3394
Email: maura.davies@saskatoonhealthregion.ca

Main office:
Saskatoon Health Region
3rd Floor – Saskatoon Square
410 – 22nd Street East
Saskatoon SK S7K 5T6
Main Number: 306-655-3300
Main Fax: 306-655-3394
Website: saskatoonhealthregion.ca

Satellite Offices

Humboldt:
Box 1930
Humboldt SK S0K 2A0
Phone: 306-682-5526
Fax: 306-682-3596
Email: dianne.eisner@saskatoonhealthregion.ca

Rosthern:
Box 309
Rosthern SK S0K 3R0
Phone: 306-232-4305
Fax: 306-232-5218
Email: perrinc.gshd@shin.sk.ca

Lanigan:
Box 1060
Lanigan SK S0K 2M0
Phone: 306-65-1430
Fax: 306-365-2099

9.2 Hospitals

See *City of Humboldt, Town of Lanigan*

9.3 Health Care Clinics and Professionals

9.3.1 Chiropractors

See *City of Humboldt*

9.3.2 Dentists

See City of Humboldt

9.3.3 Medical Clinics

LeRoy Health Clinic
211-1st Avenue Northeast
LeRoy SK S0K 2P0
Phone: 306-286-3347

- Tuesdays, Fridays

1:30pm – 5:00pm

9.3.4 Optometrists

See City of Humboldt

9.3.5 Psychologists

See City of Humboldt

9.3.6 Physiotherapists

See City of Humboldt

9.3.7 Massage Therapists

See City of Humboldt, Town of Lanigan

9.3.8 Other (including speech therapists)

See City of Humboldt

9.4 Health/Wellness Organization & Support Groups

General Inquiry Line	306 787-0146
No Charge (in Saskatchewan)	1-800-667-7766
Birth/Death/Marriage Certificates & Change of Name	306 787-3092
No Charge (in Saskatchewan)	1-800-458-1179
Drug Plan (Prescription)	306 787-3420
No Charge (in Saskatchewan)	1-800-667-7581
Family Health Benefits	306 787-3124
No Charge (in Saskatchewan)	1-800-266-0695
Environmental Services	306 798-2125

No Charge (in Saskatchewan)	1-866-450-0000
Health Line	
No Charge	1-877-800-0002
TTY Access	1-888-425-4444
Health Registration/ Health Card	306 787-3251
No Charge (in Saskatchewan)	1-800-667-7551
Out-of-Province Health Services	306 787-3475
No Charge (in Saskatchewan)	1-800-667-7523
Problem Gambling Help Line (24 Hours)	
This agency does not subscribe to Call or Name Display	
No Charge (in Saskatchewan)	1-800-306-6789

Supplementary Health Program	306 787-3124
No Charge (in Saskatchewan)	1-800-266-0695
Ministers	
Minister of Health	306 787-7345
Minister of Healthy Living Services	306 787-4983

Minister Responsible for Seniors	
Department	
Deputy Minister	306 787-3041
Acute and Emergency Services	306 787-3204
Communications Branch	306 787-3696

Community Care Branch	306 787-1501
Medical Services Plan	306 787-3475
Primary Health Services Branch	306 787-0875
Provincial Laboratory	306 787-3131
Saskatchewan Health Hotline	1-877-800-0002
Abused Women's info Line (24 Hrs)	1-888-338-0880
Kid's Help Phone (24 Hrs)	1-800-668-6868
Parents Help Line (24 Hrs)	1-888-603-9100
Partners for Rural Family Support	306 682-4135
Farm Stress Line	1-800-667-4442

Narcotics Anonymous	1-877-463-3537
Poison Control Centre	1-866-454-1212
Suicide Control Centre	306 933-6200
Pregnancy Helpline	1-800-665-0570
Smokers Helpline	1-877-513-5333
Crystal Meth Hotline/Helpline	1-877-800-0002

Frequently Called Numbers

Please note: For information on immunization, public health inspections, long term care, home care, palliative care, addictions services, mental health services, and other specific health care services, call your local RHA office.

Acquired Brain Injury Program	306 787-0802
Bursaries for Health Professionals	306 787-3060
Personal Care Homes Program Consultant	306 787-1715
SAIL (Saskatchewan Aids to Independent Living)	306 787-7121
Tuberculosis Clinic Regina General Hospital	306 766-4311
Tuberculosis Clinic Saskatoon Royal University Hospital	306 933-5684
Tuberculosis Clinic Prince Albert Community Clinic	306 953-2915
Water Testing	306 787-7138

9.5 Senior Housing

LeRoy Housing Authority
Box 64

LeRoy SK S0K 2P0

Contact: Karen Hartman 306-286-3304

- Manages 12 senior housing units
- Units are fully self contained with bathroom, living room, kitchen, bedroom, washer/dryer, fridge, stove and smoke detectors
- A common area is also available for tenant activities and recreation
- Monthly rent is based on individual income

Evergreen County Home
401-1st Avenue Northeast

LeRoy SK S0K 2P0

Contact: Brenda Nabseth 306-286-3348

- Assisted living facility
- 18 single suites, each with half bath; common living room with recreation activities; common dining room where three home cooked meals are served daily
- 4 double suites
- Wheel chair accessible
- Staffed 24 hours a day

9.6 Facilities/Services for Handicapped People

See City of Humboldt

9.7 Funeral Services/Cemeteries

See City of Humboldt

Cemeteries:

LeRoy Public Cemetery

SE 14 - 35 - 20 W2nd

Gride #761, SW corner of town

LeRoy SK S0K 2P0

Contact: RM of LeRoy Office 306-286-3261

Holy Rosary Cemetery

NW 12 - 35 - 20 - W2nd

SW corner of town (across railroad tracks)

LeRoy SK S0K 2P0

Contact: Bev Thoen 306-286-3671

10 Protective Services

10.1 Ambulance Service

911

LeRoy & District Ambulance has qualified personnel for emergencies, along with the following equipment:

- Ambulance
- Rescue Van
- Extrication Equipment

10.2 Emergency Response (First Responders)

911

See Town of Lanigan

10.3 Fire Protection

911

LeRoy & District Volunteer Fire Department
Box 40

LeRoy SK S0K 2P0

Contact: Brian Thoen, Fire Chief 306-286-3671

- Volunteer Fire Chief and 22 volunteer Fire Fighters
- 2 fire trucks
- 1 Rescue van

10.4 Police & By Law Enforcement

911

Policing services are provided by:

Royal Canadian Mounted Police (RCMP)

31 Downing Drive East

Lanigan SK S0K 2M0

Phone: 306-365-1370

Bylaw enforcement is administered by the Town Office

Contact: Ann Block, Administrator 306-286-3288

11 Real Estate/Taxation/Licensing

11.1 Automobile Licensing/Insurance

Vehicles are required to be registered and licensed according to year, make and model in Saskatchewan.

Each registered vehicle must purchase basic plate insurance which includes:

- Registration fee
- \$700 deductible for damage to most vehicles
- \$200,000 liability protection

Additional insurance coverage may be purchased if the automobile owner desires.

For detailed information please contact an Insurance Broker or check SGI website www.sgi.sk.ca

All out-of-province vehicles must go through the First-Time Registered Vehicle Inspection program to qualify for registration in Saskatchewan. Some exemptions may apply. Contact a motor license issuer closest to your location for details.

LeRoy Agencies, a Division of Western Financial Group
115 Aspen Street
LeRoy SK S0K 2P0
Phone: 306-286-3233
Fax: 306-286-3383
Email: leroy@westernfinancialgroup.net

11.2 Business Registration & Licensing Requirement

Provincial Business Registration and Related Information

Saskatchewan Justice
Corporations Branch 2nd Floor
1871 Smith Street
Regina SK S4P 3V7
Phone: 306 787-6645
Fax: 306 787-8999
Email: corporations@justice.gov.sk.ca

Education and Health Tax License (PST)
Department of Finance
Education and Health Tax
2350 Albert Street
Regina SK S4P 4A6
Phone: 306 787-6645
Toll-Free: 1-800-667-6102

Goods and Services Tax Registration (GST)
Regina Tax Services Office
Goods and Services Tax
Box 557, 1955 Smith Street
Regina SK S4P 2N9
Phone: 306 780-7279
Toll-Free: 1-800-667-7554

Employer Registration Number
(Required by all employers who make deductions for Income Tax, Unemployment Insurance, Canada Pension)
Regina Tax Services Office
Box 557, 1955 Smith Street
Regina SK S4P 2N9
Phone: 306 780-7279
Toll-Free: 1-800-667-2083

Workers Compensation Coverage (required by most employers)
Worker's Compensation Board
200 - 1881 Scarth Street
Regina SK S4P 4L1
Phone: 306 787-4370

Local Business Licensing Requirements

Home based businesses and Trades licensing fees - \$25.00 to \$100.00 per year
For further bylaw and licensing information, contact the Town of LeRoy: 306-286-3288

11.3 Development & Building Permits

Town of LeRoy

Box 40
 LeRoy SK S0K 2P0
 Contact: Ann Block 306-286-3288
 Fax: 306-286-3400
 Email: leroy@bogend.ca

All development in the Town of LeRoy is required to have a development, building, or demolition permit from the Town office. Once the development officer has received the completed permit applications, they will determine if it meets the guidelines of the zoning bylaws.

The value and number of building permits issued, by type, in the town of LeRoy for the 2003-2007 period were as follows:

TOTAL BUILDING PERMIT VALUES	2003		2004		2005		2006		2007	
	#	\$ VALUE	#	\$ VALUE	#	\$ VALUE	#	\$ VALUE	#	\$ VALUE
Residential	5	15,700	4	27,000	1	130,000		39,000		100,000
Commercial			1	15,000	1	3,000		20,000		
Demolitions			1							
Total	5	15,700	6	42,000	2	133,000		59,000		100,000

11.4 Housing (availability, types, housing costs/low costs, etc.)

LeRoy has many different types of housing available for renting or purchasing, especially single family dwellings. LeRoy Housing Authority has several townhouses available for rent, along with a selection of rental apartments.

Selected Occupied Private Dwelling Characteristics

Town of LeRoy

Total Number of Dwellings	110
Number of Owned Dwellings	145
Number of Rented Dwellings	25
Number of dwellings constructed between 1986 and 2006	15
Average value of dwellings (\$)	

Source: Statistics Canada 2006, www.statcan.ca

11.5 Municipal Taxation (including tax incentives, if any)

The property taxes in the town of LeRoy are made up of the municipal taxes and school taxes for their public school levy. The previous mill rates for each are listed in the table below.

<u>YEAR</u>	<u>MUNICIPAL</u>	<u>LANIGAN SCHOOL DIVISION NO. 40</u>
2003	14.5	20.9600
2004	14.5	20.9600
2005	18.5	17.0000
2006	18.5	20900.0000
2007	18.5	21500.0000

11.5.1 Tax Incentives

New Home Incentive

Purchase a lot from the Town of LeRoy, obtain a building permit for construction of a new home, and receive an exemption from tax assessment for two years.

Included in the incentive is 2 months free water & sewer (\$100.00 maximum), 25 REACT tags (garbage collection), and a relocation allowance of \$250.00 per family. To qualify for this incentive, applicant must reside in LeRoy for at least one year. All incentives must be approved by Town Council.

New Business Incentive

Purchase a lot from the Town of LeRoy, obtain a building permit for construction of a new business, and receive an exemption from tax assessment for two years.

Included in the incentive is 2 months free water & sewer (\$100.00 maximum). To qualify for this incentive, all applicants must remain in business in LeRoy for at least one year. All incentives must be approved by Town Council.

Existing Home Incentive

Purchase an existing home as your principle residence within the Town of LeRoy and receive a tax credit of \$500.00, 2 months free water & sewer (\$100.00 maximum), 25 REACT tags (garbage collection), and a relocation allowance of \$250.00 per family. To qualify for this incentive, applicant must reside in LeRoy for at least one year. All incentives must be approved by Town Council.

New Renter Incentive

Rent a property as your principle residence within the Town of LeRoy and receive 2 months free water & sewer (\$100.00 maximum), 25 REACT tags (garbage collection), and a relocation allowance of \$250.00 per family. To qualify for this incentive, applicant must reside in LeRoy for at least one year. All incentives must be approved by Town Council.

All new residents will receive gift certificates and promotions from some of our local businesses and recreational facilities such as:

- LeRoy School of Dance – Dance Lessons
- Midway Co-op – Membership and Coupons
- LeRoy Agencies – Braves Hockey Season Pass
- LeRoy Credit Union – Membership
- LeRoy Senior Citizens – Free Bowling Certificates

Only one coupon per family is allowed; some restrictions apply, and all applications must be approved by Town Council.

11.6 Property Value Estimates (commercial, residential, industrial, agriculture)

<u>AGE OF DWELLING</u>	<u>COST (APPROXIMATE)</u>
1981-2006 (new - 25 years old)	\$ 5,000 - \$150,000
1956-1980 (25 - 50 years old)	\$ 1,500 - \$65,000
1956 - previous (more than 50 years old)	N/A

These approximate figures will vary depending on improvements to house and/or lot

11.7 Municipal Assessment

Property taxes are determined by the assessed value placed on land and buildings and the mill rates of both the municipality and the school divisions. The total taxable assessment in the Town of LeRoy for the 2003-2007 period was as follows:

<u>YEAR</u>	<u>LAND</u>	<u>BUILDING</u>	<u>RAILWAY & PIPELINE</u>	<u>TOTAL</u>
2003	197,100	4,762,360	12,750	4,972,210
2004	194,540	4,783,320	12,750	4,990,610
2005	177,095	4,380,435	7,725	4,565,255
2006	176,725	4,446,625	7,725	4,631,075
2007	176,025	4,491,345	7,725	4,675,095

11.8 Zoning

- Urban
- Residential
- Commercial
- Railway

12 Tourism & Hospitality Services

12.1 Local Tourism Services

Town of LeRoy
Box 40, 100-1st Avenue NE
LeRoy SK S0K 2P0
Phone: 306-286-3288
Fax: 306-286-3400
Email: leroy@bogend.ca

12.2 Regional Tourism Services

East Central Tourism Region
Box 460
Yorkton SK S3B 2W4
Phone: 306-783-8707
Fax: 306-786-6978
Email: eastcentral@sasktourism.com
Website: www.eastcentral.sask.info

12.3 Provincial Tourism Services

Tourism Saskatchewan
1922 Park Street
Regina SK S4N 7M4
Phone: 306-787-9600
Toll-Free: 1-877-237-2273
Fax: 306-787-2866
Website: www.sasktourism.com

12.4 Attractions & Events

12.4.1 Local Adventure

<u>EVENTS</u>	<u>MONTH</u>	<u>CONTACT #</u>
LeRoy Leisure Lotto Dance & Final Draw	February	306-286-3288
Skating Club Carnival	March	306-286-3288
LeRoy School of Dance Recital	May	306-286-3288
Children's Bike Road-e-o	June	306-286-3306
LeRoy Community Garage Sale	June	306-286-3306
Canada Day Walk & Celebration	July	306-286-3306
LeRoy Community Summer Street Dance	July/August	306-286-3479
Terry Fox Run	September	306-286-3671
Fall Farmer's Market	September	306-287-3918
Fall Supper	October	306-286-3288
Halloween Monster Mash	October	306-286-3288
Santa Claus Day	December	306-286-3306
New Year's Eve Dance	December	306-286-3306

12.4.2 Local Annual Events

<u>Event</u>	<u>Contact</u>
LeRoy Leisureland Regional Park, LeRoy Various Golf Tournaments	Don Renz 306-286-3237

Canada Day Events, LeRoy	Patti Binsfeld	306-286-3306
Community Garage Sale, LeRoy (June)	Patti Binsfeld	306-286-3306
Ice Skating Carnival, LeRoy (March)	Ann Block	306-286-3288
Dance Recital, LeRoy (May)	Ann Block	306-286-3288
LeRoy Leisure Lotto Dance, LeRoy	Ann Block	306-286-3288

12.4.3 Local Campgrounds

LeRoy Leisureland Regional Park
 Box 305
 LeRoy SK S0K 2P0
 Phone: 306-286-3237
 Fax: 306-286-3377

Website: www.saskregionalparks.ca

- 6.4 kms west of the Town of Leroy (19.5 kms from Highway No.5)
- Open May 1 to September 30
- 20 serviced camping stalls, pull through RV sites (30 amp power)
- Firewood and ice available
- Reservations accepted
- Tenting, swimming pool, washrooms and showers
- Nine hole grass greens golf course, beach volleyball, playground, ball diamond

12.4.4 Local Culture

LeRoy & District Heritage Museum
 117-1st Avenue NE
 LeRoy SK S0K 2P0
 Phone: 306-286-3676

Contact: Shonnie Loeffler 306-287-3918

Email: leroy@bogend.ca

- Open Monday to Friday 8:30am - 5:30pm
- Off hours: By appointment

Dinner Theatre

LeRoy School

LeRoy SK S0K 2P0

Phone: 306-286-3313

LeRoy Library

100-1st Avenue NE

LeRoy SK S0K 2P0

Contact: Sebrina 306-286-3356

Fall Suppers:

Grace United Church

202 Aspen Street

LeRoy SK S0K 2P0

Contact: Pat 306-286-3286

Holy Rosary Parish

209-2nd Avenue SW

LeRoy SK S0K 2P0

Contact: Bev 306-286-3671

12.4.5 Local Eco/Agricultural Tourism

LeRoy Wildlife Federation Habitat & Enhancement Project

(Fish Pond)

- Stocked with Rainbow and Brook trout
- For directions and/or information, call 306-286-3395 (or) 365-3387

12.4.6 Local Misc. Other (Bingos, Casinos, etc)

CIA Youth Centre
Owned by the Town of LeRoy
407 West Road
LeRoy SK S0K 2P0
Phone: 306-286-3288

- For youth of all ages
- Ping pong
- Videos, Big screen TV
- Socializing

12.4.7 Local Lakes (boat launches, marinas, swimming, etc.)

LeRoy Leisureland Regional Park
Box 305
LeRoy SK S0K 2P0

Contact: Don Renz 306-286-3437

- 6.4kms west of the Town of Leroy (19.5kms from Highway No.5)
- Open May 1 to September 30
- 20 serviced camping stalls, pull through RV sites (30 amp power)
- Firewood and ice available
- Reservations accepted
- Tenting, swimming pool, washrooms and showers
- Nine hole grass greens golf course, beach volleyball, playground, ball diamond

12.4.8 Local Parks & Playgrounds

LeRoy School Playground
Corner of 4th and Willow
LeRoy SK S0K 2P0

- Playground equipment

12.5 Hospitality Services

12.5.1 Accommodations (hotels, motels, bed & breakfast facilities)

LeRoy Hotel
105-1st Avenue NE
LeRoy SK S0K 2P0
Phone:

306-286-3271

- 4 modern guest rooms with air conditioning
- Hotel has beverage room, steak pit, food services, outdoor deck and large screen television

Bonney's Bed + Breakfast
232-2nd Avenue SW
LeRoy SK S0K 2P0

Contact: Evelyn Bonney 306-286-3318

- Warm country atmosphere with home cooked meals
- Accommodates up to six people
- Weekly in-house Christian fellowship services

12.5.2 Meeting, Convention & Conference Facilities

LeRoy Wildlife Federation Hall
302 Aspen Street
LeRoy SK S0K 2P0
Phone: 306-286-3395 (or) 306-286-3387

- Capacity for 205
- Hall, kitchen, bar area

LeRoy School Gymnasium
4th Avenue NE
LeRoy SK S0K 2P0
Phone: 306-286-3313 (or) 306-286-3286

- Gymnasium, large kitchen

LeRoy Senior Centre
 201-2nd Avenue NE
 LeRoy SK S0K 2P0
 Phone : 306-286-3232
 Contact: Evelyn Bonney 306-286-3880

- Capacity for 100
- Hall, kitchen, bowling alley, pool table, shuffleboard

12.5.3 Pubs, Taverns & Lounges

LeRoy Hotel
 105-1st Avenue NE
 LeRoy SK S0K 2P0
 Phone: 306-286-3271

12.5.4 Restaurants

D's Country Kitchen
 116 Aspen Street
 LeRoy SK S0K 2P0
 Phone: 306-286-3373

LeRoy Cafeteria & Pizza
 Aspen Street
 LeRoy SK S0K 2P0
 Phone: 306-286-3445

Steak Pit
 LeRoy Hotel
 105-1st Avenue NE
 LeRoy SK S0K 2P0
 Phone: 306-286-3271

12.6 Map of Regional Tourism Attractions

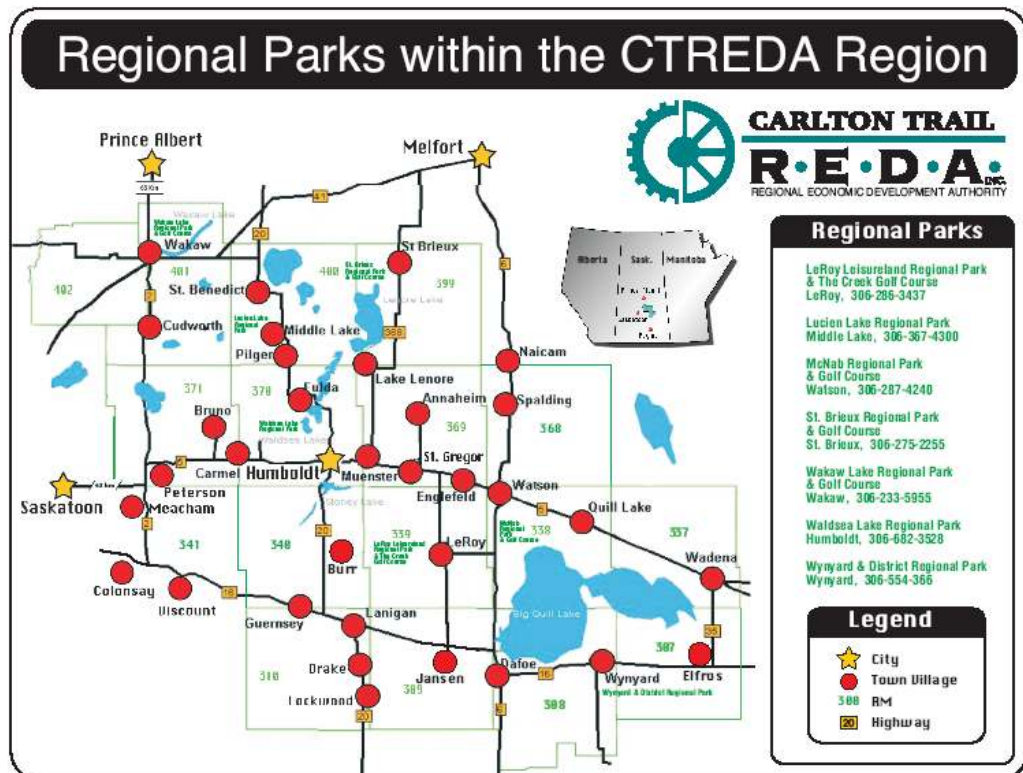

13 Transportation

13.1 Air Transportation

See *City of Humboldt, City of Saskatoon, City of Regina*

13.2 Highways (primary & secondary)

Highway No.5 and Highway No.6 are in close proximity to the Town of LeRoy

Distances To Most Travelled Points From LeRoy			
Lloydminster SK	440km	Calgary AB	779km
Moose Jaw SK	254km	Edmonton AB	690km
Yorkton SK	206km	Red Deer AB	754km
Saskatoon SK	166km	Winnipeg MB	658km
Regina SK	190km	US Border	473km

Distances source:
www.mapquest.com

13.3 Passenger Bus Service

A & S Charters
704-1st Ave. East
Watrous SK S0K 4T0
Phone: 306-946-3387

Reggie's Bus Charters
311-7th Ave
Humboldt SK S0K 2A0
Phone: 306-682-9999

Rilling Bus Ltd.
Hwy 5 East
Humboldt SK S0K 2A0
Phone: 306-682-2236

Rilling Bus Ltd.
102 Railway Ave
Lanigan SK S0K 2M0
Phone: 306-365-2066

Service Providers:

- Saskatchewan Transportation Company
For schedule information for STC locations see their website: www.stcbus.com
- Greyhound Bus Lines
For schedule information for GLC locations see their website: www.greyhound.ca

LOCATION	SERVICE BY	ADDRESS OF AGENT	TELEPHONE
Annaheim	No Service	Nearest Depot - St. Gregor	See St. Gregor
		or Muenster	See Muenster
Bruno	STC	The Mickey Mart	306-369-2244
Colonsay	GLC	Wright Insurance, 501 Railway	306-255-2030
Dafoe	STC	Yellowhead Service, Hwy 6 & 16	306-554-2096
Englefeld	STC	Hi-5 Service	306-287-3686
Guernsey	No Service	Nearest Depot - Lanigan	See Lanigan
Humboldt	STC	Kemway Lanes, 710 - 16th St	306-682-2344
Lake Lenore	No Service	Nearest Depot - Muenster	See Muenster
Lanigan	GLC	Hiway Confectionery, 116 Railway	306-365-2182
LeRoy	No Service	Nearest Depot - St. Gregor	See St. Gregor
Meacham	No Service	Nearest Depot - JCT 2 & 5	306-376-2211
Muenster	STC	Muenster Family Rest., 303 Railway	306-682-1655
Pilger	No Service	Nearest Depot - Humboldt	See Humboldt
Plunkett	GLC	Plunkett Country Hardware	306-944-4949
Quill Lake	STC	Carpet & Upholstery Care	306-383-2627
St. Benedict	No Service	Nearest Depot - Wakaw	306-233-5120
St. Brieux	No Service	Nearest Depot - Melfort	306-752-5353
St. Gregor	STC	Chuck's Place, Railway Ave	306-366-4709
Viscount	GLC	Viscount Stop & Shop, 401 Bangor Ave	306-944-4832
Wadena	STC	GK Esso, Main St & 2nd Ave	306-338-2525
Watson	STC	Kings Café, Railway Ave	306-287-3522
Wynyard	GLC	Szydlowski Holdings 101 Bosworth	306-554-2243

SASKATCHEWAN TRANSPORTATION BUS SERVICE			
TO REGINA			
DEPARTURES	ARRIVAL	DURATION	FREQUENCY
9:35	12:30	2.55 H	T/W/TH/F/SAT & HOLIDAYS
9:35	12:30	2.55 H	M
19:05	22:10	3.05 H	SUN
19:05	22:10	3.05 H	F
TO SASKATOON			
DEPARTURES	ARRIVAL	DURATION	FREQUENCY
10:13	12:15	2.02 H	M/W/F
10:13	12:15	2.02 H	T/TH/SAT
20:10	21:50	1.40 H	M/T/W/TH/F/SAT/SUN & HOLIDAYS
TO PRINCE ALBERT			
DEPARTURES	ARRIVAL	DURATION	FREQUENCY
9:35	13:45	4.10 H	F/SUN & HOLIDAYS
19:05	22:25	3.20 H	T/TH
19:05	22:25	3.20 H	M/W/F

Closest Depot is
St. Gregor

13.4 Rail

Canadian Pacific Railway
Gulf Canada Square
401-9th Avenue South West
Calgary AB T2P 4Z4
Phone: 403-319-7000
Toll Free: 1-888-333-6370

- CP rail service is from coast to coast. Mainline traffic travels through Colonsay, Jansen, Lanigan, Plunkett, Viscount and Wynyard
- CP Branch line traffic travels through LeRoy and Watson
- Main line traffic is daily, whereas branch line traffic would depend upon the freight pick up

- Freight trains included but not limited to – grain, manufactured products, industrial products, forest products, chemicals, fuel, oil, potash, fertilizers etc.

13.5 Taxi Service

See City of Humboldt

13.6 Transportation/Courier Service

- | | | |
|--------------------------------|----------------|------------------------------------------------------------------------------|
| • DHL Courier Service | 1-800-225-5345 | www.dhl.ca |
| • Purolator | 1-888-744-7123 | www.purolator.com |
| • Coutt's Courier | 306-653-3784 | www.couttscourier.ca |
| • Quill Transport | 306-668-2777 | www.quilltransport.com |
| • Kindersley Transport Limited | 306-934-1911 | www.kindersleytransport.com |
| • Ridsdale Transport | 306-668-9200 | www.ridsdale.ca |

13.7 Warehousing & Storage Facilities

See the City of Humboldt

14 Quality of Life

14.1 Quality of Life in the Town of LeRoy

In the fast paced environment of the present day, many young families have come to the realization of what their forefathers knew – that raising a family with the values and benefits of a small town atmosphere is highly desirable. LeRoy is a safe community; a community that pulls together for the good of all; one where family and community values are respected and enjoyed. There are many recreation opportunities available in LeRoy that are not available in towns of comparable size.

The people of LeRoy are passionate about creating a better environment in which to live and raise their families. With this in mind, they have taken an active role in making sure youth have all the cultural, recreational and educational amenities available to them. Low crime rates, a stable economy, reasonable housing prices and close proximity to larger urban centres makes the Town of LeRoy a great place to live.

14.2 Arts & Culture

LeRoy & District Heritage Museum
Box 47, 117-1st Avenue NE
LeRoy SK S0K 2P0
Phone: 306-287-3918

LeRoy Library
100-1st Avenue NE
LeRoy SK S0K 2P0
Phone: 306-286-3356

- Access to high speed internet
- Access to "Rosetta Stone", an "English as a Second Language" training program

14.3 Churches & Church Organizations

<u>Church and/or Organizations</u>	<u>Location</u>	<u>Contact</u>
Grace United Church	202 Aspen Street	306-286-3286
Kingdom Hall of Jehovah's Witness	501 West Road	306-286-3838
LeRoy Holy Rosary Parish	209 – 2 nd Avenue SW	306-286-3671
LeRoy Zion Lutheran Church	214 West Road	306-286-3624
St. Ignatius Church	PTNE 16-34-21-W2nd	306-365-4700
Catholic Ladies Aid		306-286-3671
Evangelical Lutheran Church Women		306-286-3237

14.4 Community Services & Organizations

<u>Organization</u>	<u>Contact</u>	<u>Phone Number</u>
LeRoy Heritage Museum	Shonnie Loeffler	306-287-3918
LeRoy Preschool	Linda Hamilton	
LeRoy School of Dance	Ann Block	306-286-3288
LeRoy Seniors	Evelyn Bonney	306-286-3232
LeRoy Wildlife Federation	Arlee Bernauer	306-365-3387

14.5 Photo Gallery

For photos, please visit www.carltontrailregion.ca.

14.6 Recreation

<u>Facility</u>	<u>Location</u>	<u>Activity</u>	<u>Contact</u>	<u>Phone Number</u>
Memorial Skating Rink	110 Centre Street	Artificial ice, large lobby with concession	Randy Nabseth	306-286-3212
Curling Rink	104 Centre Street	Two sheets artificial ice,	Jerry McGrath	306-286-3312

Softball, baseball	School grounds	concession Various sports, 3 ball diamonds
-----------------------	----------------	--------------------------------------------------

Sports Group	Contact	Phone Number
LeRoy & District Recreation Board	Randy Nabseth	306-286-3212
LeRoy Braves Senior Hockey	Doug Bley	306-286-3254
LeRoy Leisureland Regional Park		306-286-3437
LeRoy Minor Ball	Rick Block	306-286-3353
LeRoy Rink Board	Doug Bley	306-286-3254
LeRoy Skating Club	Lila Sweet	306-286-3423

14.7 Automotive Services

Auto Service and Repairs	2	Car Washes	1
Bulk Fuel Stations	2		
Gas Bars	2		

14.8 Shopping

Grocery Stores	1	Liquor Vendor	1
Hardware/Lumber Stores	1	Convenience Stores	1
Computer Stores	1	Video Rental Outlets	1



These profiles were prepared by the Carlton Trail Regional Economic Development Association with the co-operation of the Municipalities. Carlton Trail REDA reserves the copyrights.